



MV MERMAID I INDONESIA 2012 - 2013 GUEST INFORMATION PACK KOMODO RAJA AMPAT MISOOL AMBON BANDA SEA ALOR LEMBEH

Revised Dec 2011

MV Mermaid I is proud to offer our exciting 2012 and 2013 Indonesia schedules to you. We dive the best of the best, we know where and when it's running! As well as our awesome Bali-Komodo-Bali cruises we now also dive the truly spectacular destinations of Lembeh, Raja Ampat, Ambon, Banda Sea, Alor, Triton Bay and Cenderawasih Bay ! While some destinations for Mermaid I are new, it is not new to many of our dive and boat crew who have spent years in these waters. Your guests will not be disappointed!

MV Mermaid I is a 28 metre, double engine steel motor yacht. She comfortably holds 15 guests in 1 Master State Room (king size bed), 1 Single and 4 Deluxe Cabins (double or twin beds) and 2 Budget Cabins (double/twin beds) below deck. The master, single and deluxe cabins have ensuite bathrooms, refrigerator and panoramic sea view windows. The budget cabins are below decks with ensuite bathroom and refrigerator. All cabins are air conditioned, have flatscreen TV and DVD players, bathrobes and toiletries and loads of fluffy towels. Our huge purpose built dive deck and wide stern dive platform with two exit ladders and fresh water showers are a diver's dream. 6 camera rinse tanks means your valuable equipment is well looked after. Delicious Thai, Indonesian and western meals are served in our "Sawasdee Restaurant" with large windows to enjoy the views or how about trying our delicious BBQs ! After meals relax in our saloon with our TV/DVD and music center, or select from our extensive library and full range of marine life books. There are two outside decks, one shaded with outside seating and the fabulous sundeck with sunshade plus cushioned sun beds – a great place to relax. **NITROX** is available on every cruise.



MV MERMAID I 2012 PRICE LIST
BALI-KOMODO-BALI or BALI-KOMODO- MAUMERE or REVERSE !

Cabin Type	No. Cabins	No. Guests	Price Gross per Guest 2012
		15	10 days/9 nights – 28 dives
Budget	2	4	€ 2,000
Deluxe	4	8	€ 2,300
Single	1	1	€ 2,500
Master	1	2	€ 2,500
Charter Price	Cabins	No. Guests	Price Gross
Full Charter	All Cabins	15	€ 33,900
Please ask about our specials for full boat charters!			
Group Price	Cabins	No. Guests	Price Gross
Minimum of 8 Guests		8	as per cabin selection/availability
Please ask about our special for groups !			

MV MERMAID I 2012 PRICE LIST
SORONG -RAJA AMPAT-SORONG & BIODIVERSITY SPECIALS

	No. Cabins	No. Guests	Price Gross per Guest 2012		
		Total 15	Raja Ampat	Biodiversity Specials	
			10 days/9 nights	16 days/15 nights	15 days/14 nights
			30 dives	50 dives	46 dives
Budget	2	4	€ 2,200	€3,550	€3,300
Deluxe	4	8	€ 2,600	€3,750	€3,500
Single	1	1	€ 2,800	€3,950	€3,700
Master	1	2	€ 2,800	€3,950	€3,700
Charter Price	Cabins	No. Guests	Price Gross	Price Gross	Price Gross
Full Charter	All Cabins	15	€38,000	€56,050	€52,300
Please ask about our specials for full boat charters !					
Group Price	Cabins	No. Guests	Price Gross		
Minimum 8 guests	As selected	8	as per cabin selection/availability		
Please ask about our specials for groups!					

MV MERMAID I 2013 PRICE LIST
BALI-KOMODO-BALI or BALI-KOMODO- MAUMERE or REVERSE!

Cabin Type	No. Cabins	No. Guests	Price Gross per Guest 2013
		15	10 days/9 nights – 28 dives
Budget	2	4	€ 2,100
Deluxe	4	8	€ 2,400
Single	1	1	€ 2,600
Master	1	2	€ 2,600
Charter Price	Cabins	No. Guests	Price Gross
Full Charter	All Cabins	15	€ 35,400
Please ask about our specials for full boat charters !			
Group Price	Cabins	No. Guests	Price Gross
Minimum of 8 Guests	As selected	8	as per cabin selection/availability

Please ask about our specials for groups full boat charters!

**MV MERMAID I 2013 PRICE LIST
SORONG-RAJA AMPAT-SORONG , RAJA AMPAT TO LEMBEH
& BIODIVERSITY SPECIALS**

	No. Cabins	No. Guests	Price Gross per Guest	
		15	Raja Ampat or Lembeh	Biodiversity Special
			10 days/9 nights	16 days/15 nights
			30 dives	50 dives
Budget	2	4	€ 2,400	€3,550
Deluxe	4	8	€ 2,700	€3,750
Single	1	1	€ 2,900	€3.950
Master	1	2	€ 2,900	€3,950

Charter Price	Cabins	No. Guests	Price Gross	Price Gross
Full Charter	All Cabins	15	€39,900	€56,050

Please ask about our specials for full boat charters !

Group Price	Cabins	No. Guests	Price Gross
Minimum of 8 Guests	As selected	8	as per cabin selection/availability

Please ask about our specials for groups !

Transfers: Price

SOUTH BALI:

Airport, Nusa Dua, Jimbaran, Kuta Beach, Seminyak, Benoa, Sanur Beach Free of Charge

CENTRAL AND NORTHERN BALI :

Price per person each way: Ubud, Padangbai, Candi Desa, Tanah Lot €30

Price per person each way: Amed, Tulamben, Lovina Beach, Permuteran etc €50

MAUMERE, RAJA AMPAT & LEMBEH:

Transfers from/to airport and destinations within 1 hour of Maumere or Sorong Free of charge

Other transfers – price on application eg Lembeh to Manado, Sorong to Island Resort On application

On Board Courses Price Price

EANX Nitrox	Incl materials	€185
Advanced Open Water	Incl materials	€220
Digital Underwater Photographer	Incl materials/excl camera	€150
Discover Scuba Diving	1 st dive/repeat dives	€125/175

Specialty Courses:

Peak Performance Buoyancy Workshop, Deep Diver, Drift Diver, Multilevel/Computer Diver, Night Diver, Underwater Naturalist, Underwater Photographer (excl camera rental) €175

Ask about our Special Photography Workshops Please ask!

Rental Equipment Set/Item Price Per Day



**Mermaid Liveboards is proudly an
Aqua Lung Partner Centre**
Quality equipment rental – compare rental costs
versus excess baggage charges and save!

Full Set- items marked *	Full Set*	€18
BCD*	item	€6
Regulator – with octopus and gauges*	set	€6
Wetsuit -- shorty*	item	€6
Wetsuit – long*	item	€6
Mask/Snorkel*	set	€5

Hooded Vest	item	€6
Full Foot Fins*	item	€6
Open Heel Fins plus Boots	set	€8
Compass	item	€5
Dive Torch	item	Free
Weights/weight belt	item	Free
Surface Marker Buoy	item	Free
15 Litre tank – subject to availability	item	Free
Underwater Camera – per day	excl.strobe	€20
Dive Computer	Item	€5

*As a safety precaution **Dive computers are mandatory for each individual diver***

Important: Please advise equipment requirements in advance and give sizes when booking

Others	Per	Price
National Park and Port Fees – Komodo, Alor	Person	€90
National Park and Port Fees – Raja Ampat, Lembah or Biodiversity Special	Person	€150
Nitrox – 32%	Per fill	€6
Nitrox Packages:		
Mermaid I – Komodo	Package	€130
Mermaid I – Raja Ampat or Lembah	Package	€140
Mermaid I – Biodiversity Special	Package	€240
Mermaid II – Komodo	Package	€ 96
Mermaid II – Raja Ampat	Package	€120
DVD Burn	DVD	€10
Red and White Wine	bottle	€20-€40
Beer	can	€2
Soft Drinks/ Fruit Juices		Free
Electrolytes		Free
Mermaid T-shirts		€15
Mermaid Polos		€20

NOTE: All prices are applicable for 2012-2013 only. Mermaid Liveboards retain the right to alter prices without prior notice and/or introduce any additional charges as is deemed necessary. US \$/Euros are accepted on board at the boats exchange rate for that cruise. *All cruise prices are commissionable. All other prices are non commissionable.* Port and National Park Fees are subject to change depending on government regulation



MV MERMAID I - INDONESIA - 2012

Trip No.	Departure Date	Arrival Date	Destination	No Days/Nights
MMI 22/12RJ	Tue 3 Jan 12	Thu 12 Jan 12	Raja Ampat	10/9
MMI 23/12RJ	Sat 14 Jan 12	Mon 23 Jan 12	Raja Ampat	10/9
MMI 24/12RJ	Wed 25 Jan 12	Fri 3 Feb 12	Raja Ampat	10/9
MMI 25/12RJ	Sun 5 Feb 12	Tue 14 Feb 12	Raja Ampat	10/9
MMI 26/12RJ	Thu 16 Feb 12	Sat 25 Feb 12	Raja Ampat	10/9
MMI 27/12RJ	Mon 27 Feb 12	Wed 7 Mar 12	Raja Ampat	10/9
MMI 28/12RJ	Fri 9 Mar 12	Sun 18 Mar 12	Raja Ampat	10/9
MMI 29/12RJ	Tue 20 Mar 12	Thu 29 Mar 12	Raja Ampat	10/9
MMI 30/12RJ	Sat 31 Mar 12	Mon 9 Apr 12	Raja Ampat	10/9
MMI 31/12RJ	Wed 11 Apr 12	Fri 20 Apr 12	Raja Ampat	10/9
MMI 32/12RM	Sun 22 Apr 12	Mon 7 May 12	Biodiversity Special! Sorong-Raja Ampat- Banda Sea – Alor - Maumere Flores	16/15
MMI 33/12MB	Tue 8 May 12	Thu 17 May 12	Maumere-Komodo-Bali	10/9
	Fri 18 May 12	Sat 9 Jun 12	In port Bali	
MMI 34/12K	Sat 9 Jun 12	Mon 18 Jun 12	Bali-Komodo-Bali	10/9
MMI 35/12K	Mon 18 Jun 12	Wed 27 Jun 12	Bali-Komodo-Bali	10/9
MMI 36/12K	Wed 27 Jun 12	Sat 7 Jul 12	WWF Charter - Full	10/11
MMI 37/12K	Sat 7 Jul 12	Mon 16 Jul 12	Bali-Komodo-Bali	10/9
MMI 38/12K	Tue 17 Jul 12	Thu 26 Jul 12	Bali-Komodo-Bali	10/9
MMI 39/12K	Fri 27 Jul 12	Sun 5 Aug 12	Bali-Komodo-Bali	10/9
MMI 40/12K	Mon 6 Aug 12	Wed 15 Aug 12	Bali-Komodo-Bali	10/9
MMI 41/12K	Thu 16 Aug 12	Sat 25 Aug 12	Bali-Komodo-Bali	10/9
MMI 42/12K	Sun 26 Aug 12	Tue 4 Sep 12	Bali-Komodo-Bali	10/9
MMI 43/12K	Wed 5 Sep 12	Fri 14 Sep 12	Bali-Komodo-Bali	10/9
MMI 44/12K	Sun 16 Sep 12	Tue 25 Sep 12	Bali-Komodo-Bali	10/9
MMI 45/12K	Wed 26 Sep 12	Fri 5 Oct 12	Bali-Komodo-Bali	10/9
MMI 46/12K	Fri 5 Oct 12	Sun 14 Oct 12	Bali-Komodo-Bali	10/9
MMI 47/12K	Sun 14 Oct 12	Tue 23 Oct 12	Bali-Komodo-Bali	10/9
MMI 48/12K	Wed 24 Oct 12	Fri 2 Nov 12	Bali-Komodo-Bali	10/9
MMI 49/12K	Fri 2 Nov 12	Sun 11 Nov 12	Bali-Komodo-Bali	10/9
	Sun 11 Nov 12	Fri 16 Nov 12	In port Bali	6/5
MMI 50/12BM	Fri 16 Nov 12	Sun 25 Nov 12	Bali- Komodo-Maumere	10/9
MMI 51/12SP	Mon 26 Nov 12	Tue 11 Dec 12	Biodiversity Super Special! Maumere-Alor-Banda Sea-Raja Ampat-Sorong !	16/15
MMI 52/12RJ	Wed 12 Dec 12	Fri 21 Dec 12	Raja Ampat	10/9
MMI 53/12RJ	Sun 23 Dec 12	Tue 1 Jan 13	Raja Ampat	10/9

MV MERMAID I - INDONESIA - 2013

Trip No.	Departure Date	Arrival Date	Destination	No. Days/Nights
MMI 01/13RJ	Thu 3 Jan 13	Fri 12 Jan 13	Raja Ampat	10/9
MMI 02/13RJ	Sun 14 Jan 13	Tue 23 Jan 13	Raja Ampat	10/9
MMI 03/13RJ	Wed Jan 24 13	Sat 2 Feb 13	Raja Ampat	10/9
MMI 04/13RJ	Sun 3 Feb 13	Tue 12 Feb 13	Raja Ampat	10/9
MMI 05/13RJ	Wed 13 Feb 13	Sat 23 Feb 13	Raja Ampat	10/9
MMI 06/13RJ	Sun 24 Feb 13	Tue 5 Mar 13	Raja Ampat-Lembah	10/9
MMI 07/13RJ	Wed 6 Mar 13	Sat 16 Mar 13	Lembah-Raja Ampat	10/9
MMI 08/13RJ	Sun 17 Mar 13	Tue 26 Mar 13	Raja Ampat	10/9
MMI 09/13RJ	Wed 27 Mar 13	Sat 6 Apr 13	Raja Ampat	10/9
MMI 10/13RJ	Sun 7 Apr 13	Tue 16 Apr 13	Raja Ampat	10/9
MMI 11/13SP	Thu 18 Apr 13	Fri 3 May 13	Biodiversity Special ! Sorong-Raja Ampat- Banda Sea -Alor- Maumere Flores	16/15
MMI 12/13MB	Sun 5 May 13	Tue 14 May 13	Flores-Komodo-Bali	10/9
MMI 13/13K	Tue 14 May 13	Sun 2 Jun 13	In port Bali	20/19
MMI 14/13K	Sun 2 Jun 13	Tue 11 Jun 13	Bali-Komodo-Bali	10/9
MMI 15/13K	Wed 12 Jun 13	Fri 21 Jun 13	Bali-Komodo-Bali	10/9
MMI 16/13K	Sun 23 Jun 13	Tue 2 Jul 13	Bali-Komodo-Bali	10/9
MMI 17/13K	Tue 2 Jul 13	Thu 11 Jul 13	Bali-Komodo-Bali	10/9
MMI 18/13K	Fri 12 Jul 13	Sun 21 Jul 13	Bali-Komodo-Bali	10/9
MMI 19/13K	Mon 22 Jul 13	Wed 31 Jul 13	Bali-Komodo-Bali	10/9
MMI 20/13K	Thu 1 Aug 13	Sat 10 Aug 13	Bali-Komodo-Bali	10/9
MMI 21/13K	Sun 11 Aug 13	Tue 20 Aug 13	Bali-Komodo-Bali	10/9
MMI 22/13K	Wed 21 Aug 13	Fri 31 Aug 31	Bali-Komodo-Bali	10/9
MMI 23/13K	Sun 1 Sep 13	Tue 10 Sep 13	Bali-Komodo-Bali	10/9
MMI 24/13K	Tue 10 Sep 13	Thu 19 Sep 13	Bali-Komodo-Bali	10/9
MMI 25/13K	Fri 20 Sep 13	Sun 29 Sep 13	Bali-Komodo-Bali	10/9
MMI 26/13K	Mon 30 Sep 13	Wed 9 Oct 13	Bali-Komodo-Bali	10/9
MMI 27/13K	Thu 10 Oct 13	Sat 19 Oct 13	Bali-Komodo-Bali	10/9
MMI 28/13K	Sun 20 Oct 13	Tue 29 Oct 13	Bali-Komodo-Bali	10/9
MMI 29/13K	Wed 30 Oct 13	Fri 8 Nov 13	Bali-Komodo-Bali	10/9
MMI 30/13K	Fri 8 Nov 13	Mon 18 Nov 13	Bali-Komodo-Bali	10/9
MMI 31/13P	Mon 18 Nov 13	Mon 25 Nov 13	In Port Bali	8/7
MMI 32/13BM	Mon 25 Nov 13	Wed 4 Dec 13	Bali-Komodo-Maumere	10/9
MMI33/13SP	Thu 5 Dec 13	Fri 20 Dec 13	Biodiversity Super Special! Maumere-Alor-Banda Sea- Raja Ampat-Sorong !	16/15
MMI34/13RJ	Mon 23 Dec 13	Wed 1 Jan 14	Raja Ampat	10/9

PARK AND PORT FEES

All Bali, Flores, Alor cruises - euros 90 per person payable on board thanks

All Raja Ampat, Ambon and Exploration Cruises - euros 150 per person payable on board thanks

Fuel Surcharges: We hate Fuel Surcharges as much as you do and will our utmost to avoid them. However if fuel prices rise beyond what we can absorb then we have no choice other than pass some of the increase along to you. We will always try to keep this to a minimum.

MV MERMAID I ARRIVAL AND DEPARTURE PORTS

Cruise	Departure Port	Time	Arrival Port	Time
Bali-Komodo-Bali	Benoa Bali	13:00-15:00	Benoa Bali	08:00-08:30
Bali-Komodo-Maumere	Benoa Bali	13:00-15:00	Maumere Flores	08:00-08:30
Maumere-Komodo-Bali	Maumere Flores	12:00-14:00	Benoa Bali	08:00-08:30
Raja Ampat - Lembeh	Sorong Papua	12:00-18:00	Lembeh Bitung	08:00-08:30
Lembeh – Raja Ampat	Lembeh Bitung	12:00-14:00	Sorong Papua	08:00-08:30
Raja Ampat	Sorong Papua	12:00-18:00	Sorong Papua	08:00-08:30
Biodiversity Special	Maumere Flores	12:00-14:00	Sorong Papua	08:00-08:30
Biodiversity Special	Sorong Papua	12:00-14:00	Maumere Flores	08:00-08:30

Bali-Komodo-Bali is as per the above. All other areas, given the remoteness, flight connections etc please keep in close contact with us and contact our travel team if you need any assistance
info@mermaid-liveboards.com Travel Team +62 811 386940 **Mermaid Hotline +62 81 337 778 077**

ITINERARIES – ALL CRUISES



Day	MV MERMAID I ITINERARY BALI-KOMODO-BALI	Dives
Day 1	Check-in on board MV Mermaid I between 13:00-15:00 hours in Bena Harbour Bali. After the boat and safety briefing, equipment is prepared then settle into your cabin. Dinner is served at approx. 19:00 hours as e cruise overnight to Moyo Island off the north west coast of Sumbawa	0
Day 2	Start your adventure with a great dive in the calm, clear waters of Angel Reef at Moyo Island. Massive elephant ear and barrel sponges, schools of long fin banner fish and red tooth triggers In their hundreds, frog fish, nudibranchs, eels, surgeon fish, snapper, dog tooth tuna checking out what is for lunch ! Visit the local village then its lunch for us ! Then we cruise to Satonda Island for a macro dive followed by a world class night dive after watching a million bats fly at sunset. After a great dive and dinner we cruise overnight to Sangeang Volcano off the north coast of Sumbawa.	3
Day 3	The Nusa Tenggara region has some extremely interesting and unique marine life. Today we spend the day diving around Sangeang Volcano - 2-3 dives for rare nudibranchs, pygmy seahorse, leaf scorpion fish, blue ribbon eels, black sand diving with all its treasures and underwater hot springs that supports this very unique marine environment. Night dive here too or head on over to Gili Banta for the chance for Star Gazers and coral cat shark.	4
Day 4	Current depending, we start the day at GPS Point Gili Banta famous for its sharks and pelagic fishes. Then we enter the Komodo National Park and for more exhilarating blue water/fish soup diving ! Gili Lawalaut has several great dives - if the tide is right we hunt grey reef shark and dolphin at Taka Toko Gili Lawalaut. Lighthouse Reef and The Old Passage offer fast drifts with pelagics, maybe manta ! Crystal Rock offers awesome soft corals in gold and orange hues plus the chance for sharks, turtles, Giant Maori wrasse, a "fish soup" dive. Tonight we dive the famous Pink Beach - spectacular colours and Frogfish, slipper lobster, basket stars, robust sea cucumbers unique to the area plus more !	4
Day 5	Start your day with an exciting visit to Loh Liang Komodo National Park to walk with the dragons ! And as we quietly walk through the bush setting look out for Komodo dragons, deer, wild boar and birds. Then relax as we cruise south to dive the Three Sisters or Pillarsteen at Padar Island. Next stop is a diver's paradise - Horseshoe Bay Rinja Island - home of one of the top 10 dives in the world- Cannibal Rock - an abundance of corals, sponges, ascidians, sea apples, black corals, turtle, cuttlefish, loads of reef fishes too ! Here we can also watch dragons scavenging on the beach, monkey, deer, wild pigs along the shore, go beach combing.... Maybe even a chance to follow whales and dolphin feeding in the calm bay. We overnight at this peaceful place, diving at one of the many fabulous spots.	3
Day 6	More world class dives today as we relax in Horseshoe Bay Rinja Island - the Yellow Wall of Texas is absolutely stunning covered with enormous yellow soft corals. Go slowly along the wall looking for unique creatures but don't forget to look out into the blue to see what's coming by...maybe e make a deep dive to check if the tiny yellow pygmy seahorses are on the giant gorgonians at depth.	4

Nusa Kode offers more walls and critter chances coupled with white tip reef sharks etc ! Torpedo Alley is famous for its "electric" rays and perhaps one of the best night dives of your life for critter fanciers

Day 7	Today we'll head on over to Manta Alley to watch in awe as these magnificent creatures feed, play and get cleaned at the many cleaning stations. In the afternoon we can check out more big fish dives maybe at Loh Serah, Tatawa Kecil or the infamous "Current City" Batu Bolong - come face to face with reef sharks, turtles and giant Wrasse. Many good night dives around here - Gili Darat is great for sleeping turtles, colourful reef stonefish, Spanish dancers - calm sea - a good place to sleep.	4
Day 8	The diving around Gili Lawalaut, Tatawa Kecil, Gili Darat is so awesome you will all want more so today we make 2-3 dives in clear arm blue waters - loads of fish both big and small. Then we'll head off for a a night dive at either Gili Banta or maybe Batu Putih in Sumbawa - both interesting sites. Overnight we cruise back to Satonda and Sumbawa - solar powered nudibrancs, ghost pipefish anyone ?	4
Day 9	We enjoy two good dives around Sumbawa and Moyo Islands - a chance to shoot anything you missed at the trip beginning. Then the crew wash your equipment for you while you relax on the sundeck or downloading your pictures, enjoying our trip video as well just before dinner with all your new friends.	2
Day 10	After breakfast we transfer you ashore at 9am to continue your vacation...or its time to head home to start planning your next Mermaid cruise !	0

TOTAL DIVES 28



Day	MV MERMAID I ITINERARY SORONG-RAJA AMPAT-SORONG	Dives
Day 1	Check-in on board MV Mermaid I. As guest arrivals take place all through the day depending on flights you are welcome to board when you arrive and spend some time looking around Sorong, gearing up etc. Following the boat and safety briefing - its overnight to the Misool area. It is almost impossible to put together a daily itinerary due to the magnificent diving everywhere we go. No trip is the same with so many different sites to visit and explore. If there is somewhere in particular you really have your heart set on please discuss with the Cruise Director who will do their utmost to get you there – conditions, ship and your safety allowing!	0
Day 2 -4	Misool area – with literally 100's of dives around this magnificent area we will be in diver's paradise for a few days. Soft corals, gorgonians – some of the prettiest corals in the world – and the kingdom of the pygmy seahorse ! Pinnacles with masses of fish. Blue water mangroves (crocs depending!) Islands we will thoroughly enjoy the Misool area including Sagof Islands, Wagma and Farondi islands; Wailbatan and Warakaret Island, Kalig, Pele Islands	12

Day 5-8	<p>Fiabacet and Farondi Islands and after the 3rd dive of the day spend some time going around the lagoons in the dinghy for amazing sights and wildlife. Then we may head north to Waigeo Island</p> <p>Perhaps we will spend the day around Batanta Island, a black sand environment – great muck diving !</p> <p>The Mantas call us to Dampier Strait where they hang out at their cleaning stations. But this place is also fabulous for macro diving with critters such as Pegasus, Pontohi Pgymy Seahorse, pipefish etc. And two dives at a small island called Arborek, with a lovely village and a jetty great for diving ! The jetty pillars are covered in soft corals – a photographer’s delight and also good for macro such as signal gobies, nudibrancs and more Pohtohi’s etc. Dive around the island of Kawe a great place for schooling fish, and beautiful reefs covered in black coral bushes. And dive Alyui Bay (or a full day around Alyui Bay). In Alyui Bay there is a pearl farm. We can tour the pearl farm and learn how they harvest the pearls, and the whole process of pearl farming. You can even buy pearls. Diving in Alyui bay is good for macro and wide angle. Walls covered in soft corals and sea fans with lots of nudies and pygmy’s. Also a great night dive in the jetty; Raja Epaulette Shark (walking sharks), wobbegongs, crocodile fish, toadfish and frogfish. Dive around the island of Yanggefo - beautiful mangrove areas, stunning reefs covered in orange and purple soft corals, and submerged reef with lots of schooling fish, and pygmies. The Strait of Dampier is also well known for the amount of schooling fish. There are several pinnacles with zillions of fish. Also the tips (capes) of several islands with again lots of schooling fish; schools of barracudas, school of big eye jacks, snappers, zillions of fusiliers and surgeonfish, etc.... And lots of wobbegongs</p>	16
Day 9	<p>2 dives in the Strait of Dampier. More of the same. Fish, fish, fish, glorious corals and all! Then back to Sorong we must go. The crew will take care of rinsing and packing your equipment during this 4-5 hour run</p>	2
Day 10	<p>After breakfast we transfer you ashore to continue your vacation...or its time to head home to start planning your next Mermaid Liveaboards cruise ! With so many new itineraries and opportunities to choose from you will be back and back and back for more and most welcome on board Mermaid Liveaboards – Asia’s Premier Liveaboard Fleet !</p>	0
TOTAL DIVES		30

Biodiversity Specials

Map is under construction 😊

Difficult to get the crew out of the water to prepare as they are having such a wonderful time !

Day	MV MERMAID I ITINERARY BIODIVERSITY SPECIAL	Dives
Day 1	<p>Check-in on board MV Mermaid I. As guest arrivals take place all through the day depending on flights you are welcome to board when you arrive and spend some time looking around Sorong or Maumere, gearing up etc. Following the boat and safety briefing - its overnight to the first dive area.</p>	0

Day 2 -14	<p>It is almost impossible to put together a daily itinerary due to the magnificent diving everywhere we go. No trip is the same with so many different sites to visit and explore. If there is somewhere in particular you really have your heart set on please discuss with the Cruise Director who will do their utmost to get you there – conditions, ship and your safety allowing! However here is rough guide just to whet your appetite ! (it will be in approximately in reverse if you start from Maumere)</p> <p>4 dives around Pulau Kri, Dampier Strait, South Waigeo. 4 dives around Dampier straits. 4 dives around Mansuar, Arborek, and or Yangeffo (including the Mantas and some mangroves and the Jetty at Arborek, which photographers love). Dampier Strait 3 dives around Sagof, Balbulol and/or Farondi, Misool, Raja Ampat. 4 dives around Fiabacet, Misool, Raja Ampat 4 dives around Pulau Warakaraket, Pulau Boo, and Fiabacet. All in Misool, Raja Ampat. 3 dives at Pulau Koon. Cruise to Misool. 3 dives around Banda, and cruise to Pulau Koon (Southeast Seram). 11 hours. Here can also stay 1 more day in the Bandas.....flexible schedule can be discussed with guests on board. 3 dives in Lucipara and cruise to the Banda Islands. 4 daylight dives in Gunung Api (volcano with snakes). Cruise to Lucipara (also known as Pulau Penyu) 4 dives around Pulau Wetar (no night dive, but sunset dive) and cruise to Gunung Api 3 dives around Alor, and cruise overnight to Pulau Riun, next to Pulau Wetar 4 dives in the Alor Strait 2 dives around Pulau Serbete (Northeast Flores), and 2 dives Tg Wai Au (Pulau Kawula, before Alor). Cruise overnight to Alor.</p>	50
Day 16	<p>After breakfast we transfer you ashore to continue your vacation...or its time to head home to start planning your next Mermaid Liveaboards cruise ! With so many new itineraries and opportunities to choose from you will be back and back and back for more and most welcome on board Mermaid Liveaboards – Asia’s Premier Liveaboard Fleet !</p>	0

TOTAL DIVES	48-50
--------------------	--------------

MV MERMAID I

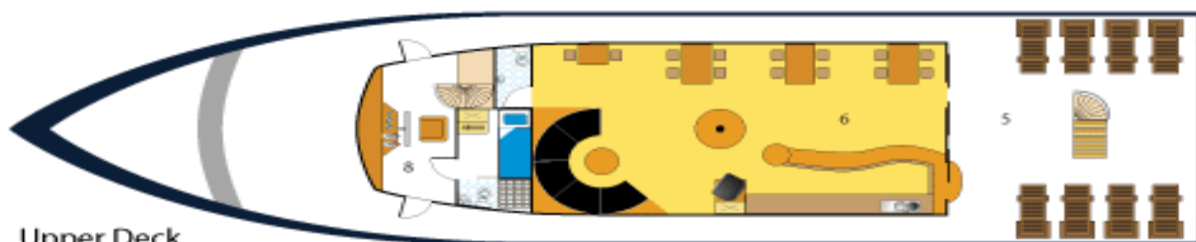

Upper Deck

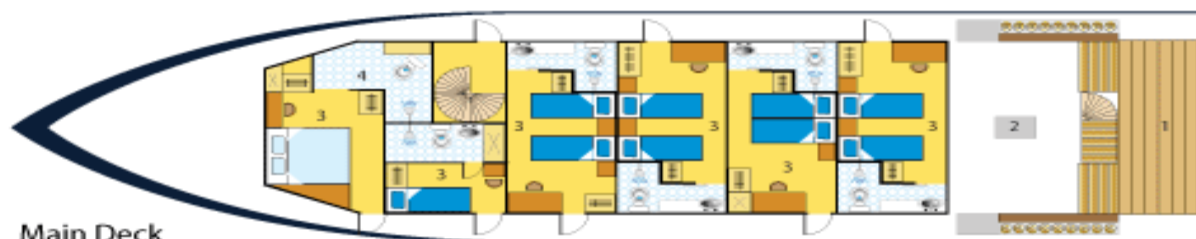

Main Deck

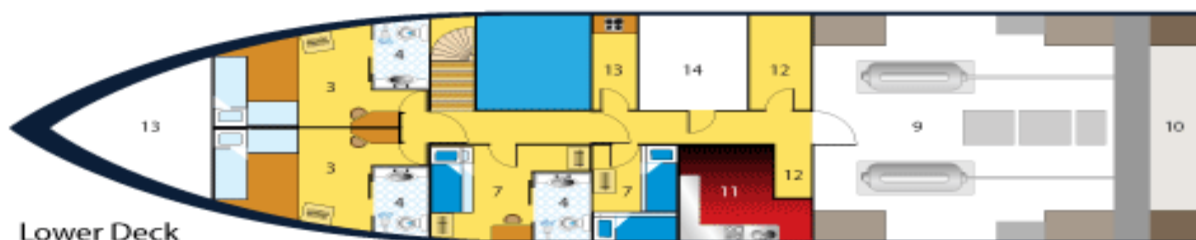

Lower Deck

Length	28 m / 94 feet	15 guests in 7 double/twin + 1 single cabin
Beam	7 m / 21 feet	3 x staff cabins
Draft	2.5 m / 8 feet	10 bathrooms with hot water
Water	20.000 l + watermaker	2 stern back deck showers
Fuel	18.000 l	1 a/c saloon with flat screen TV, DVD, music, flat screen TV's + DVD's in every cabin
Cruising Speed	9.5 knots	Large film, book library
Max Speed	12 knots	Dive Platform: 16 sqm
Dinghies/RIBS	2 x 4.2 m / ladders	Dive Deck: Massive 42 sqm with 6 rinse tanks and 3 camera set up areas + air blowers
Engines	Hino 2 x 450 HP	Hot fluffy towels after each dive
Generator	Hino 2 x 150 KVA	Sundeck and bath towels
Compressor	Bauer 3 x 215 l / min	Minimum 300 thread count bed linens
Nitrox Membrane	600l/min 32-36%	

Air-Conditioner

Central/in room
control

Hotel style sprung beds and bases

MV MERMAID I

FAQ'S

TRIP INFORMATION



Please feel free to email info@mermaid-liveboards.com for any questions or assistance

Number of Dives/Site selection: Each itinerary outlined the approximate number of dives planned for each cruise destination. This is always subject to weather conditions and security/safety issues. Dive site selection detailed in the published itinerary is subject to change by the Captain or Cruise Director without prior notice. There are numerous fantastic sites in all the areas we visit and our objective is to take you to the best of the best ! Repeat guests – we'll take you to some new sites or more of those you really love!

What diver certification level is needed for diving in Indonesia ? :

Everyone is welcome on board, no matter what level your certification. Dive groups and site selection will be chosen to meet your safety, comfort and diving ability – and is subject to the discretion of the Cruise Director. Our professional dive crew will take you on the easy route or to another site if you don't like currents. If you are up for it, we'll take you right into it for all the action the site offers ! You may wish to bring a reef hook for some dive sites.

Dive Guides and Diver Safety: Our experienced dive crew would be delighted to assist you. Divers are welcome to dive with their buddy on sites deemed suitable by the Cruise Director. **For diver safety the use of individual dive computers is mandatory for all divers.** Nitrox fills and courses are available on board to enhance your diving safety. Please allow 24 hours between last dive and flying. Guests are requested to show diving certification cards on checking in and are strongly recommended to have valid dive insurance (Padi, Dan or equivalent).

Departure and Arrival Times:

Bali Departures: Boarding time at Bena Passanger Pier at Bena Harbour Bali is between 13:00-15:00 hours for our 16:00 hour departure. Please try to arrive in time to make these times or contact us to. Final cruise departure time is subject to guest arrival times. Please liaise with Mermaid Liveboards if your flight times cannot fit this schedule. Transfers from/to the airport or hotels in the south are free of charge. From destinations in central and northern Bali, there is a small charge. Please refer to the price list.

Guests arriving before 12 noon on departure day will be transferred to Mermaid Liveboards at Sanur Beach where you can leave your luggage in safety till boarding transfer at 14:00 hours. After meeting the friendly crew at All 4 Diving you can relax on the beach, enjoy a massage, and go sight-seeing or shopping till 14:00 hours when you will be transferred to the vessel.

Bali Transfer Times: 12:30 – Nusa Dua, Ullawatu, Canggu, Kerobokan, 13:00 Jimbaran, Seminyak. 13:30 Kuta Beach, Legian, 14:00 Sanur Beach; 11:00 Tulamben; 12:00 Candi Desa, Padangbai, Ubud.
The time is to be advised for Lovina Beach and other locations in Bali.

Maumere Flores Transfer Times: We will meet all flights and bring you straight to the vessel on cruise departure day or from your hotel by approx.12 noon. Guests are recommended to arrive one day prior, to enjoy the beauty of the surrounding area and to be sure you can make your cruise connection. Why not visit the Three Colour Lakes in the

craters of Keli Mutu volcano! Please contact us on info@mermaid-liveaboards.com to assist you with hotel, flight and transfers.

Lembeh – Manado Transfer Times: *This cruise does not focus on Lembeh so it is a great idea to combine a Lembeh land based dive trip with your cruise for the best of the best ! We will meet you at the airport or your hotel in Manado City area by 12pm to transfer to the vessel on cruise departure date. Or if you are staying in Lembeh, we will coordinate the best method to collect you and advise. If you arrive early why not dive Bunaken or Bangka islands or Lembeh or take a highland tour to visit local flower market and lunch in a restaurant located above Tondano Lake. Feel free to contact us at info@mermaid-liveaboards.com for any assistance. Transfers from/to the airport and within Manado city are free of charge. Price on application for other locations.*

Sorong Raja Ampat Transfer Times: We will co-ordinate your arrival and collect you from the airport or your hotel and bring you direct to the vessel. There are several reasonable hotels in Sorong plus there are some wonderful island retreats around and about that you may wish to stay at before or after your cruise. We are happy to assist with ground transport, accommodations, resort stays/local diving, air fares etc. Please contact info@mermaid-liveaboards.com

Domestic Flights: The majority of local flights need to be booked in Indonesia. Some airlines accept internet bookings such as Silk Air and Lion Air and surely more will come on line too. However we are happy to assist info@mermaid-liveaboards.com and we only add a nominal service fee to cover admin fees. Guests are strongly advised to arrive at least 1 day prior to their cruise to avoid any delays.

Water Temperature and Wetsuit recommendations:

Bali-Komodo-Bali: The Flores Sea with its usually clear blue waters, great visibility has water temperatures of approx. 26-28 degrees (northern dive locations) – a 3-5 mm shorty is okay with most guests comfortable with a 3-5mm long. The Sumba Sea (southern dive locations) has an average temperature of approx. 24 degrees – the awesome diving lets you forget about the cooler waters! Think about a 5mm long possibly adding a vest or renting a shorty to go over the top if you feel the cold. Hood, gloves and booties are strongly recommended for these cooler waters. The Alor region can also share some surprisingly cool waters like Komodo so a thicker suit is recommended and we have rentals available on board.

Raja Ampat/Misool area : The water temperature around the 4 Kings of Raja Ampat and Misool area is 28-30 degrees Celsius year round. We recommend a 3 mm long wetsuit. If you get chilly, maybe a vest for under you suit.

Biodiversity Special: Water temperatures will range between 26-30 degrees Celsius. We have a selection of long and short wetsuits on board which you can rent if you are cold or change into if you are too warm in your suit.

Equipment on board: Rental is charged on a per diving day basis. Full rental equipment is available. Dive computers are mandatory – 1 per diver. Please advise your rental equipment needs including sizes when you book. Both vessels carry mostly 12 litre tanks plus some 15 litre tanks available. There is no additional cost for a 15 litre tank or 15 litre nitrox fill – however it is subject to availability and the Cruise Director's discretion as to who needs the larger tanks on each cruise. Tank valves are international and some DIN adapters are available on board. Any dive equipment failure or loss will require you to rent a replacement from Mermaid Liveaboards at our published rates. If Mermaid Liveaboard equipment is lost/damaged, full replacement cost will be charged at the discretion of the Cruise Director. Published equipment prices are available on board.

Camera Stations: There are several large tables on the dive deck with many rinse containers for small to super large camera/video setups. There are several power points in every cabin plus throughout the saloon area for charging. Usually our dive crew will have a laptop available in case you experience any problems with yours. As possible, we also offer a DVD burning service in case you cannot bring your laptop with you.

Electrical current and plugs: 220 volts is standard throughout the boat. 110v adapters are available. Please ask the Tour Leader on boarding if you are not sure what to use. We have a few adapters on board. The cabins can handle both the following plug types:-



Meals: Our Thai cook is excellent, preparing a variety of Thai, Indonesian and Western dishes. Please advise any special meal requirements on the guest information form.

Currency: Please pay all on board costs in € Euros, \$ US or Indonesian Rupiah. We can also accept credit card payment for all on board costs. We suggest you also have some rupiah for souvenir shopping, massages, small items etc. Exchange rates vary throughout Indonesia – the further away from Bali the lower the exchange rate. The airport's rate is lower than the rate you find at most small currency exchanges in Bali. Bank rates are low and take a long time. \$ US and € Euros are accepted by the souvenir sellers in the Komodo National Park but rupiah is preferred. There are several currency exchange services and ATM machines near Mermaid Liveaboards in Sanur and in all areas we cruise. Have a plentiful supply of rupiah for the more exotic cruises as the local villagers will come to the vessels with affordable and magical souvenirs you will not be able to resist.

Luggage and what should I bring: All luggage will be taken on board. If you have large bags you do not need on the trip, please arrange to leave at your hotel if possible or at Mermaid Liveaboards in Sanur. Other items you may need on board are bathing suits, shorts, t-shirts, sunscreen, mosquito repellent and a light weight jacket or sweater. Good walking shoes for your time in Komodo National Park and also walking through the jungles in search of the wondrous Bird of Paradise in Raja Ampat ! (Trainers are fine – slip on sandals not recommended).

Can I be contacted while on board: Both our vessels are equipped with state of the art satellite phone systems. The numbers are **Mermaid I - IDD code +870 773 185 631 and for Mermaid II IDD code + 882 167 606 0355** Guests can keep in touch with the families and loved ones at many points throughout their cruises via mobile phone and the Tour Leader will advise when signal is available. For added security, please note the satellite number and share with families and friends as the phones are on 24/7. Incoming calls and outgoing calls are available for a nominal fee of euros €3 per minute. If there is any difficulty getting through, please don't hesitate to call our Hotline Number Indonesia +62 81 337 778 077 and + 62 811 386 940 and we will assist you

Insurance: You need 2 types of insurance when planning your dive holiday – 1) Diving insurance is strongly recommended due to the high cost for you should you have a diving accident and require hospitalization and/or hyperbaric chamber care. Please contact www.diversalertnetwork.org to check which Dan area can cover you. Click on About Dan for links to all the Dan organizations around the world.

2) General travel/cancellation insurance. There are several companies around the world that can assist and one we can suggest is www.worldnomads.com for reliable and professional service recommended by The Lonely Planet.

Please note: *If you are unable to make your dive trip and the date has past our cancellation terms and conditions we are very sorry but regardless of the circumstances we cannot refund or transfer to another date.*

Medical Assistance: We cruise to remote areas however we are prepared to handle most accident or medical emergencies. Mermaid's management team is available 24 hours a day via our satellite communications to expedite tried and tested emergency evacuation plans to the nearest recompression chamber and/or hospital in Bali or Makasaar or the nearest available chamber. Our dive crews are first aid trained and we have an extensive first aid kit on board plus loads of emergency oxygen. Please bring any of your own medications that you may need. You can help as well by making sure you are in good condition for diving – prevention is always better than the cure. Please remember to dive safely and to make sure your Dan Diver's Alert Network or other dive insurance is up to date.

Malaria: Raja Ampat area

There is malaria in the region for the Raja Ampat cruise – this area is around the equator and we recommend you discuss this with your doctor. Certainly when we walk in the jungle early mornings you will need to cover up well and also use mosquito repellent. We have a supply on board but suggest you bring your preferred brands. And from the Raja Ampat Tourism Association: Papua is a malaria area and you are advised to take precautions and follow the advice from your local health centre. Note that the medication Lariam has limited effectiveness in this area due to a resistant strain of Malaria and is not recommended. Alternatives could be Malarone or doxycycline.

Malaria – Komodo area

Generally speaking basic precautions such as covering at dawn/dusk and using mosquito repellent for land tours is satisfactory. If you are in doubt whatsoever, please liaise with your doctor.

Children's Policy: Diving child 10 years or older - pays full diver price. Non diving child 12 years or older - pays full non diver rate. Child 12 years or under - non diving - pays 50% of diver rate if shares with 2 parents/guardians Child 12 years and under - non diving - pays full non diver rate if sharing with only 1 parent/guardian. Parents/guardians have to be with

the child at all times. If both parents want to dive and the child remains on board, we will hire an additional dive crew - at euros 40 per day x total number of cruise diving days - at the parent's cost to supervise the child's activities only while the parents/guardians are in the water. Please give a minimum of 4 weeks' notice to arrange this service.

I want to dive and visit and see and do...: There is loads of excellent diving in and around your holiday destination as well. Mola Mola season in Bali is mainly from August to early October but starts as early as June – plan at least 2 days for Nusa Penida for a chance to see these magnificent creatures. Contact your agent for special Liveaboard + local diving/accommodation packages. Detail how many days/diving days you would like, what class accommodation and we our Travel Team who will recommend and arrange a hassle free package to suit you info@mermaid-liveboards.com

MERMAID LIVEBOARDS

General Booking, Cancellation, Payment and others policies effective date December 2011

Acceptance of the booking means that you and/or your agent agree to the terms and conditions as outlined below in their entirety. Payments are to be made by telegraphic transfer in Euros, **remitter to pay all charges**, to the account nominated on your invoice only. Please send a copy of your transfer advice by scan email to info@mermaid-liveboards.com as soon as you process payment and we will confirm receipt as soon as it arrives in our bank.

Alternatively you may choose to pay via PayPal to email address info@mermaid-liveboards.com Please note: we accept guest payments via PayPal for all invoiced services. PayPal can charge to your credit card or bank account – as per your instructions. Sorry we do not accept cruise payments via Credit Card, Traveler's cheques, Personal cheques or Money orders. On board sales are accepted in Euros, US dollars, Indonesia Rupiah or via credit card at no fee. Please note on board credit card charges will be processed in Indonesian rupiah only as per government regulation.

When you accept the booking from Mermaid Liveboards and PT Indonesia Liveboards you accept all responsibility for any/all payments including making the payment *by the due dates*. If payments are not received by the due date, the space will be automatically released for resale and any monies already paid subject to the cancellation terms and conditions set out below.

Mermaid Liveboards reserves the right to alter published rates without prior notice and/or to introduce any other fees as deemed necessary by the company eg fuel surcharges. Mermaid Liveboards is held accountable solely to the laws of Indonesia and as they apply to the parent company - PT Indonesia Liveboards. Any contractual laws from countries other than Indonesia remain the responsibility of the guest to manage. National Park and Port fees are subject to increase and/or amendment by government policy and are out of the control of Mermaid Liveboards and PT Indonesia Liveboards.

Prices include: Transfers from/to airport and all free of charge points outlined in our FAQ section, all meals & snacks, coffee, tea, hot chocolate, soft drinks and drinking water, tanks, weights, weight belts and diving with experienced Dive masters/Instructors.

Prices do not include: Transfers outside of the free of charge zones outlined in our FAQ section , national park/Port Fees Komodo/Alor cruises €90, Raja Ampat cruises €150, Fuel Surcharges if applicable, Nitrox fills (€6), rental equipment, on board courses, massages, souvenirs and alcoholic beverages

IMPORTANT NOTES: Please fill in the guest information form *when you book your cruise* and forward immediately to Mermaid Liveboards via email info@mermaid-liveboards.com Please ensure you provide an email address and phone contact number for each guest plus complete the emergency contact information section.

VIP: All passports must have a minimum of 6 months validity including the period you will be in Indonesia plus some free pages. Failure to have a valid passport may have you stranded in your home country or another country outside of Indonesia !

Transfer information is required to be provided a minimum of 4 weeks prior to the cruise. Guests may go directly to the Mermaid Liveaboard vessel in port however please contact info@mermaid-liveboards.com to check on arrangements and suitable times

All divers are required to complete a liability release waiver and to show proof of diving certification and dive medical insurance such as Padi, Dan or equivalent on check in. *Please have these available in your hand luggage.*

Payment and cancellations - the fine print:

FIT and Group Bookings (less than 8 pax): Deposits, Payments and Cancellations -

Deposit	30% within 10 days of booking
Final Payment	60 days prior to departure
Last Minute Bookings ie less than 60 days	100% payment within 2-3 days of booking or before boarding for bookings made on day of departure

Cancellations:

More than 90 days prior departure:	Refund of deposit less €100.00 administration charge
90 to 60 days prior departure:	Deposit lost
Less than 60 days prior departure:	No Refund

Full Boat Charter or Group Bookings Deposits, Payments and Cancellations -

Mermaid I (8 or more guests) Mermaid II (9 or more guests) :

Any special concessions for privately booked groups or full boat charters become null and void if you cancel any guest. If group/charter payment terms are not met, the space will be immediately released for resale and cancellation terms below will be applied.

- **10% non-refundable deposit** is required **within 10 business days** of booking
- **next 25%** of the total cost to be paid **at least 120 days before** the cruise departure date
- **Balance, 65%** of the total cost to be paid **at least 90 days before** the cruise departure date.

Cancellations:

More than 120 days before the departure date: all payments will be refunded, less the 10% initial deposit.

Less than 120 days but more than 90 days before the departure date: all payments will be refunded, less 35% of the total cost. If cancellation is made for part of the charter/group then the refund will be pro-rated accordingly

ie. All payments for the cancelling guests will be refunded less 35% of the total cost of each cancelling guest

Any free of charge concessions will be lost in their entirety as these are given only as an incentive for Full Charter bookings.

Less than 90 days before the departure date: no refunds will be made and date transfers are not accepted for any reason.

Mermaid Liveboards and PT Indonesia Liveboards reserve the right to cancel any trip if there is less than the equivalent of 3 deluxe cabin guests. We will do our utmost to transfer guests to a vessel we deem to be of Equal or better standard. Alternatively, we may ask the guest to transfer to the date before/after the cruise. In the event none of these options are possible, we will offer a full refund (allow maximum 1 week process time)

Mermaid Liveboards and PT Indonesia Liveboards do not accept any legal liability for loss or damage to any luggage or dive equipment while being transferred to/from the vessel nor while on board. We will offer every assistance possible to help with any insurance claims for lost or damaged property. Guests will be charged for repair/replacement of damaged/lost equipment deemed by the Tour Leader/Cruise Director/company management to have occurred due to the guest's negligence

Lastly, Mermaid Liveboards nor PT Indonesia Liveboards do not offer refunds in the event of personal injury, airplane delay, mechanical breakdowns, weather, sickness, strikes, war, criminal acts, quarantine, acts of god, if another guest requires immediate evacuation and the vessel must return to port or any other event beyond its actual control

Guests are strongly advised to have valid dive medical, travel and cancellation insurances. Guests are also strongly recommended to plan their holidays to arrive in the departure ports at least 1 day prior to the cruise. Please remember you are going to some truly exotic locations where the infrastructure is still being developed.

M/V Mermaid I & II - Welcome On Board !

Mermaid Liveboards Hotline Indonesia +62 081 377 778 077

Need to speak with someone who speaks Bahasa ? please call +62 811 386 940

Registered Company Operations Address:

Mermaid Liveboards – Bali Guest Lounge
PT Indonesia Liveboards

53 Jl Danau Tamblingan
Sanur Beach Bali Indonesia 80228

Registered Company Address:-

CMC Marine Ltd
12F New Victory House
93-103 Wing Lok Street Central Hong
Kong

info@mermaid-liveboards.com

www.mermaid-liveboards.com